



10 Swannington Road

, Coalville, LE67 3NE

£525,000

A beautifully upgraded four double bedroom detached home offering over 2,300 sq ft of stylish, contemporary living. Set on a generous plot, the property combines high-quality finishes with practical family living, including a spectacular open-plan kitchen dining space, triple detached garage/workshop with annex potential, and beautifully landscaped rear garden.

THE PROPERTY

A elegant panelled entrance hall sets the tone for this seriously interior-led home. The ground floor flows effortlessly from a sophisticated living room with striking media wall, through to the showstopping living kitchen — crowned with an orangery roof, flooded with natural light and finished with bespoke Kingswood cabinetry, a large island, integrated drinks station and concealed bar. Bi-fold doors open directly to the garden, while underfloor heating and a second media wall add comfort throughout.

A versatile study works equally well as a home office or gym. The exceptional Kingswood utility room includes clever storage, a W.C. and boot room — keeping family life beautifully organised. Upstairs, the generous landing leads to a luxurious master suite with contemporary grey ensuite, a second double bedroom with its own ensuite, a third double currently used as a treatment room, and a further single bedroom. The family bathroom is a real statement, centred around a striking pebble-shaped bath. A staircase off the landing rises to an expansive attic room — ideal as a guest bedroom or private retreat.

- Comprehensively renovated and extended by current owners creating a stunning family home
- Spectacular living kitchen with orangery roof, bi-fold doors, and bespoke Kingswood kitchen featuring large island and barrister drinks station with hidden bar
- Two striking media walls adding contemporary style to living spaces
- Impressive triple garage/workshop with potential for annex conversion (STPP) + Private Driveway for several vehicles
- East-facing sunny garden with patio, lawn, and secure gated access
- Stylish family bathroom with pebble-shaped feature bath
- Four bedrooms - Master & Bedroom Two both with modern ensembles
- Versatile study/gym, exceptional utility room by Kingswood Designs with W.C. and boot room
- Generous attic room providing flexible guest accommodation or private retreat

Viewing

Please contact our Berkley Leicester Office on 0116 2544755 if you wish to arrange a viewing appointment for this property or require further information.



4



3



2



C

Floor Plan

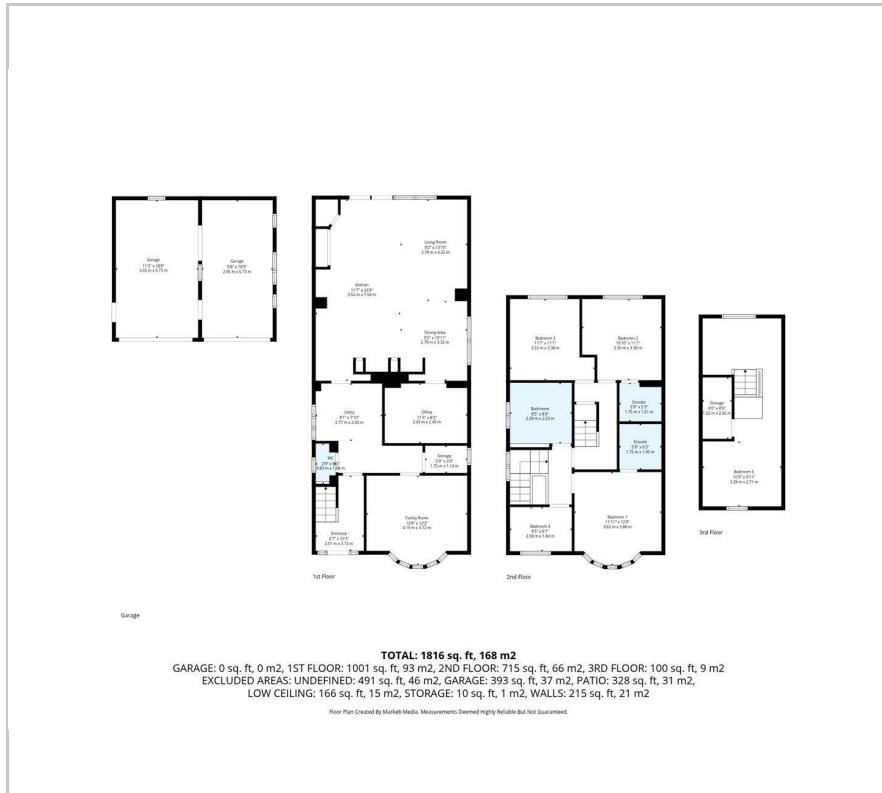

Area Map

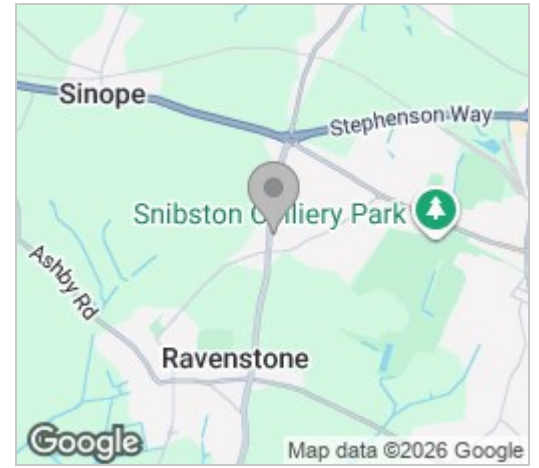

Energy Efficiency Graph

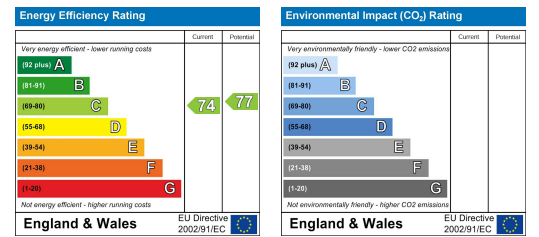

These particulars, whilst believed to be accurate are set out as a general outline only for guidance and do not constitute any part of an offer or contract. Intending purchasers should not rely on them as statements of representation of fact, but must satisfy themselves by inspection or otherwise as to their accuracy. No person in this firms employment has the authority to make or give any representation or warranty in respect of the property.